

AREA STATEMENT

AREA OF LAND (AS PER SURVEY)	3830.356 + 3353.146	SOQA	7183.502
(PREVIOUS)	(ADDED)		
AREA OF LAND (AS PER DEED)	3930.356 + 3301.372	SOQA	7231.728
(PREVIOUS)	(ADDED)		
PERMISSIBLE GROUND COVERAGE	1571 + 2092.66	SOQA	3663.66
(PREVIOUS)	(ADDED)		
PERMISSIBLE F.A.R. # 3		SOQA	27895.229
USES PERVIOUS F.A.R. AREA IN BLOCK A & BLOCK B		SOQA	15368.56
PROPOSED BUILDING HEIGHT		SOQA	30 M. (0+24)

PROPOSED BUILD UP AREA BLOCK-C (HORD)

FLOOR	BASE L.A. AREA (SQM)	CORNER CUT	AREA (SQM)	CONSTRUCTION
GROUND	142.57	0.00	142.57	PORCELAIN
1ST	142.57	0.00	142.57	CONCRETE
2ND	142.57	0.00	142.57	CONCRETE
3RD	142.57	0.00	142.57	CONCRETE
4TH	142.57	0.00	142.57	CONCRETE
5TH	142.57	0.00	142.57	CONCRETE
6TH	142.57	0.00	142.57	CONCRETE
7TH	142.57	0.00	142.57	CONCRETE
8TH	142.57	0.00	142.57	CONCRETE
9TH	142.57	0.00	142.57	CONCRETE
10TH	142.57	0.00	142.57	CONCRETE
11TH	142.57	0.00	142.57	CONCRETE
12TH	142.57	0.00	142.57	CONCRETE
13TH	142.57	0.00	142.57	CONCRETE
14TH	142.57	0.00	142.57	CONCRETE
15TH	142.57	0.00	142.57	CONCRETE
16TH	142.57	0.00	142.57	CONCRETE
17TH	142.57	0.00	142.57	CONCRETE
18TH	142.57	0.00	142.57	CONCRETE
19TH	142.57	0.00	142.57	CONCRETE
20TH	142.57	0.00	142.57	CONCRETE
21TH	142.57	0.00	142.57	CONCRETE
22TH	142.57	0.00	142.57	CONCRETE
23TH	142.57	0.00	142.57	CONCRETE
24TH	142.57	0.00	142.57	CONCRETE
25TH	142.57	0.00	142.57	CONCRETE
26TH	142.57	0.00	142.57	CONCRETE
27TH	142.57	0.00	142.57	CONCRETE
28TH	142.57	0.00	142.57	CONCRETE
29TH	142.57	0.00	142.57	CONCRETE
30TH	142.57	0.00	142.57	CONCRETE
31TH	142.57	0.00	142.57	CONCRETE
32TH	142.57	0.00	142.57	CONCRETE
33TH	142.57	0.00	142.57	CONCRETE
34TH	142.57	0.00	142.57	CONCRETE
35TH	142.57	0.00	142.57	CONCRETE
36TH	142.57	0.00	142.57	CONCRETE
37TH	142.57	0.00	142.57	CONCRETE
38TH	142.57	0.00	142.57	CONCRETE
39TH	142.57	0.00	142.57	CONCRETE
40TH	142.57	0.00	142.57	CONCRETE
41TH	142.57	0.00	142.57	CONCRETE
42TH	142.57	0.00	142.57	CONCRETE
43TH	142.57	0.00	142.57	CONCRETE
44TH	142.57	0.00	142.57	CONCRETE
45TH	142.57	0.00	142.57	CONCRETE
46TH	142.57	0.00	142.57	CONCRETE
47TH	142.57	0.00	142.57	CONCRETE
48TH	142.57	0.00	142.57	CONCRETE
49TH	142.57	0.00	142.57	CONCRETE
50TH	142.57	0.00	142.57	CONCRETE

CURBOARD AREA IN BLOCK-ABB - 218.01 SQM.

LAND USE	TYPE	AREA (SQM)	PERCENTAGE
GROUND COVERAGE	PLANTATION AREA	188.74	26.113%
	PAVED AREA	1296.74	13.189%
ROAD AREA	ROAD AREA	261.756	26.660%
	OTHER GREEN AREA	161.59	0.175%
SERVICES	RESIDENTIAL	104.669	1.134%
	COMMERCIAL	923.743	100.00%
NET LAND AREA			218.01 SQM

AREA STATEMENT - PHASE-I

Ground Area	1076.88 SQM
Plantation Area	188.74 SQM
Paved Area	1296.74 SQM
Road Area	261.756 SQM
Other Green Area	161.59 SQM
Services	104.669 SQM
Residential	923.743 SQM
Commercial	923.743 SQM
TOTAL	4787.24 SQM

PARKING CALCULATION

BLOCK	FLOOR	PLAT NAME	B.U.A. (SQM)	NO. OF RATS	TOTAL AREA (SQM)
BLOCK A	FLAT A	1801.13	10	1801.13	
	FLAT B	672.50	10	672.50	
	FLAT C	672.50	10	672.50	
	FLAT D	672.50	10	672.50	
	FLAT E	672.50	10	672.50	
BLOCK B	FLAT F	672.50	10	672.50	
	FLAT G	672.50	10	672.50	
	FLAT H	672.50	10	672.50	
	FLAT I	672.50	10	672.50	
	FLAT J	672.50	10	672.50	
TOTAL			70	3500.00	

CERTIFICATE OF BUILDING PLAN

THIS IS TO CERTIFY THAT THE BUILDING PLAN FOR BLOCK A, B & C IN THE CURBOARD AREA IN BLOCK-ABB - 218.01 SQM, HAS BEEN APPROVED BY THE ARCHITECTURAL OFFICE, MUNICIPAL CORPORATION, MADRAS.

DATE: 13.10.2023

OFFICIAL SIGNATURE: [Signature]

OFFICIAL NAME: [Name]

OFFICIAL DESIGNATION: [Designation]

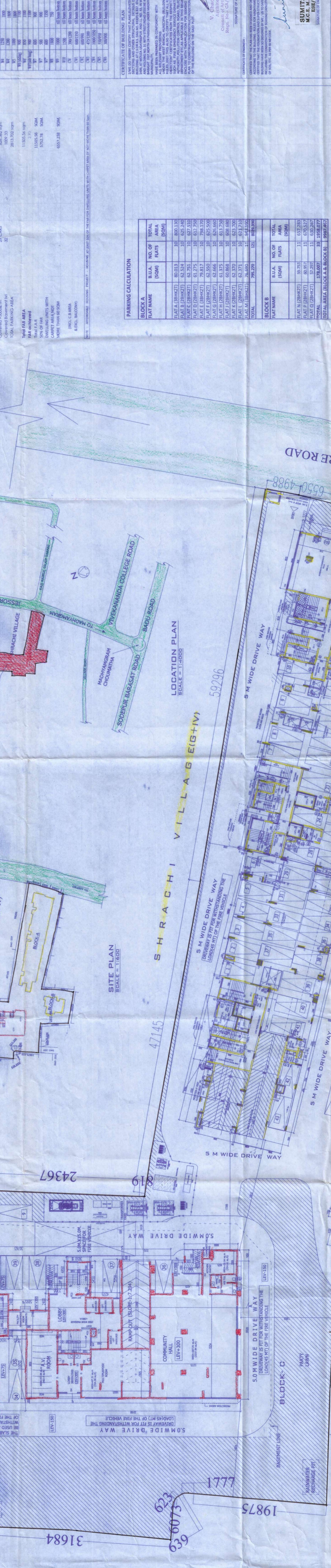
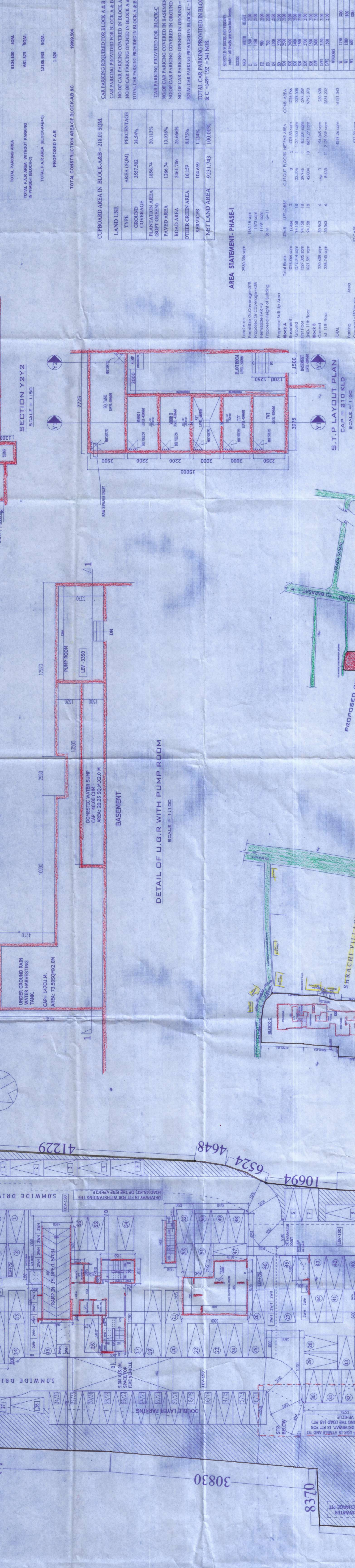
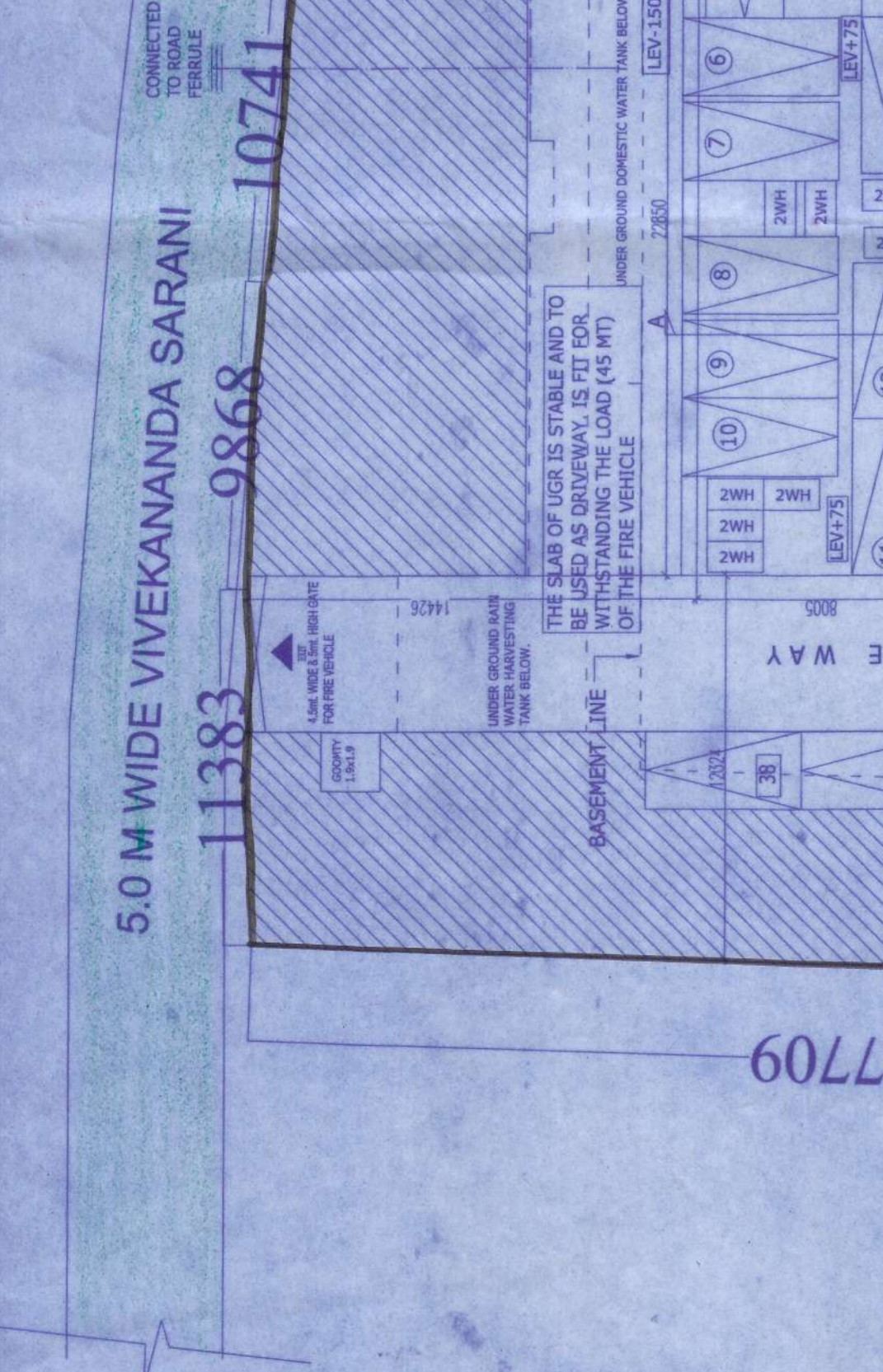
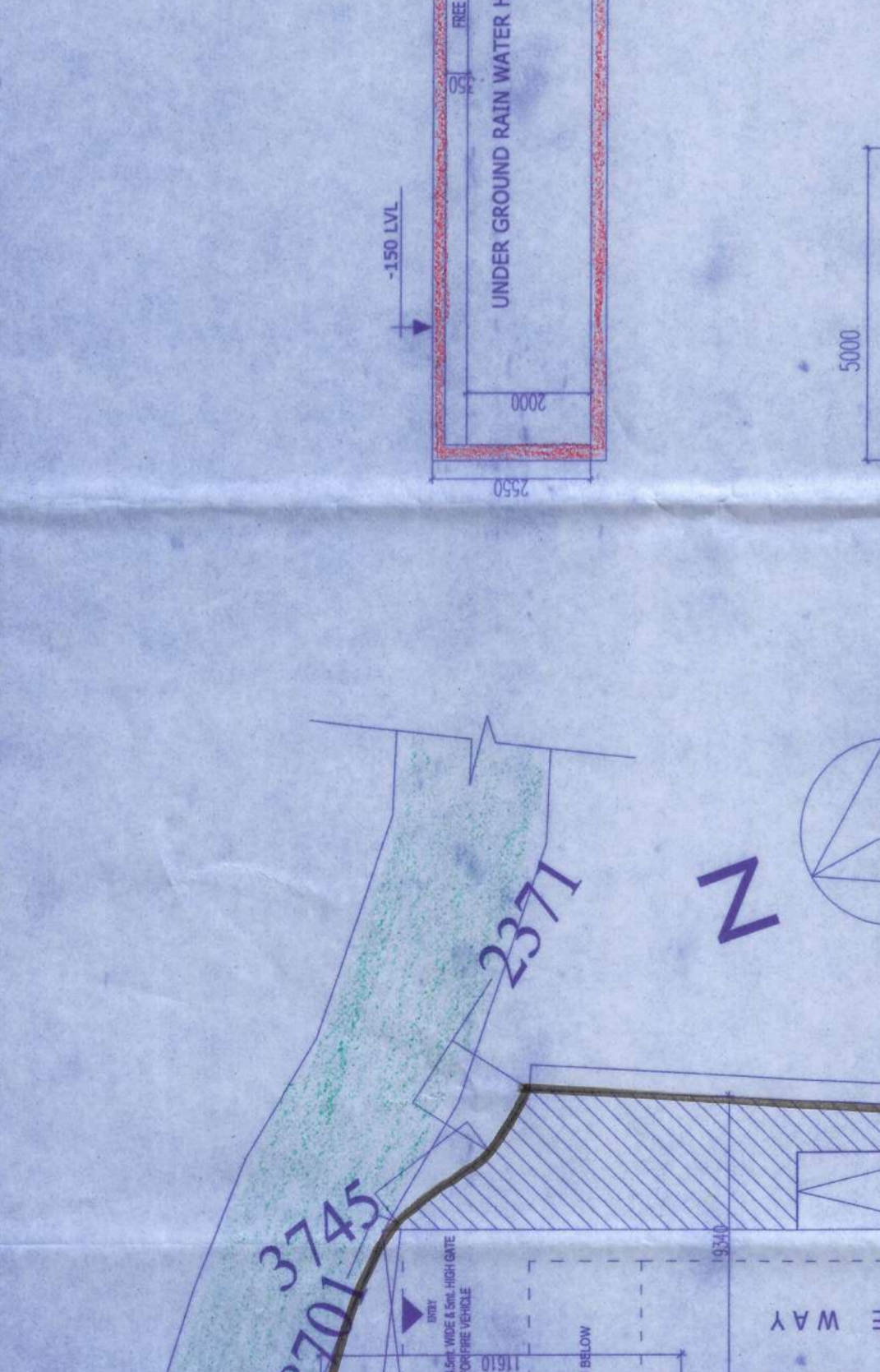
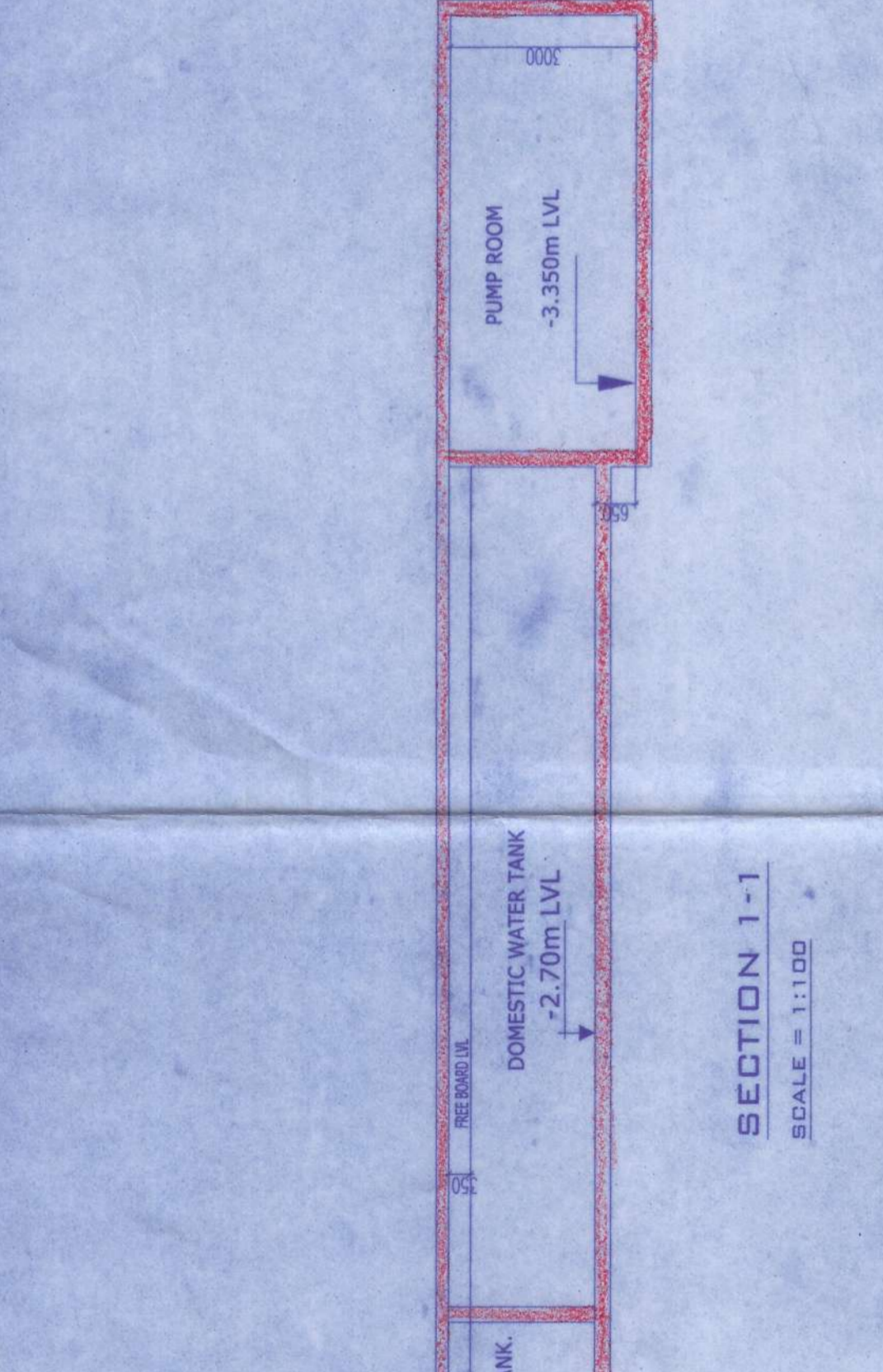
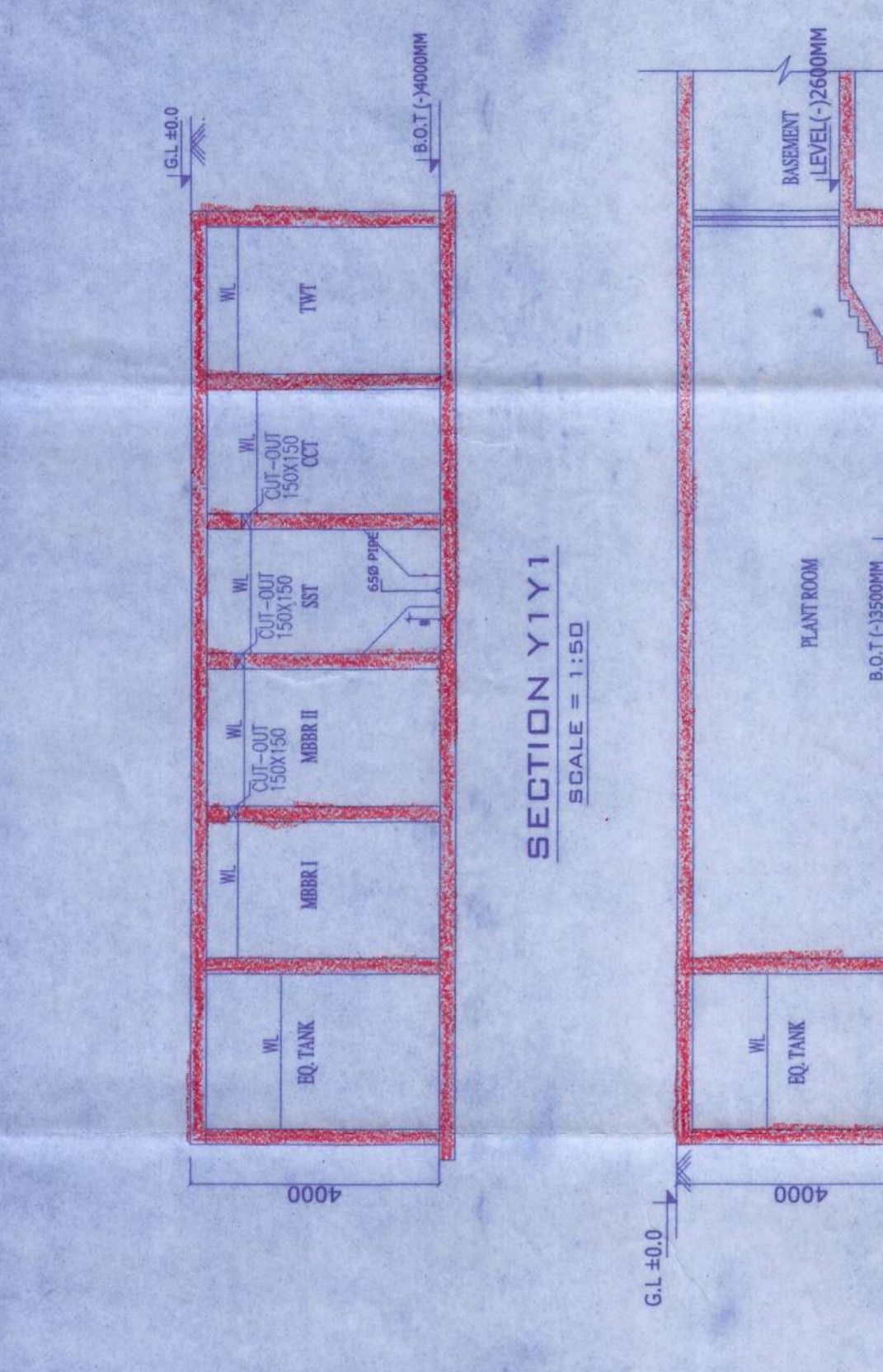

GROUND FLOOR PLAN
BLOCK-A, B & C BLOCK - SCALE = 1:200

SHRACHI VILLAGE (G+IV)

BLOCK-A
OCCUPANCY CERTIFICATE
MR. NO. 274 DATED ON 06.06.2023

BLOCK-B
OCCUPANCY CERTIFICATE
MR. NO. 274 DATED ON 06.06.2023

BLOCK-C
OCCUPANCY CERTIFICATE
MR. NO. 274 DATED ON 06.06.2023

SANCTIONED
On 23.11.2023
P.A. No. 274/2023
M.M.C. No. 274/2023

BUILDING PLAN COMMITTEE
MEETING DATE: 13.10.2023

ARCHITECTS:
THE DESIGN CELL
KOLKATA - 700 001